

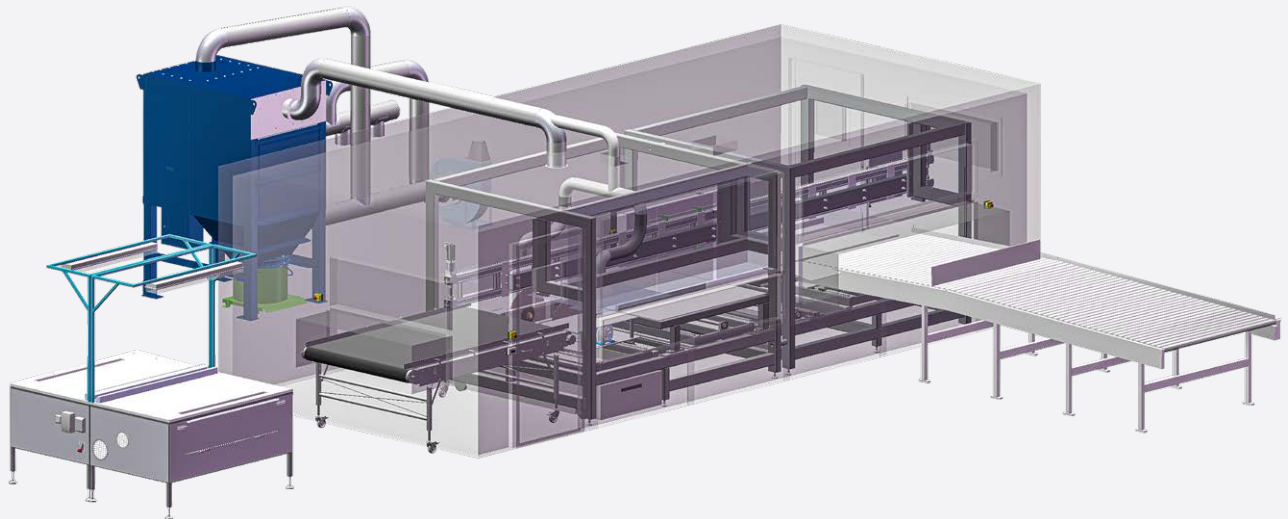

FPP 80/100 – FLAT PANEL PROCESSOR

Faster, more automated and with serial connect option

WORLD NEWS!



FPP 100



mrtsystem.com

GENERAL INTRODUCTION

Our largest version of flat panel processor is up to 65 % faster than previous versions and with the ability to serial connect more FPPs to the same feeding line.

FPP is a versatile highly performing machine to disassemble a large range of LCD panels. The processor allows for secure extraction of the fluorescent lamps and separation into the different fractions.

The processor can be fed manually or mechanically via conveyor belts. The FPP cutters automatically make 2 cuts at the perimeter of the panel, allowing clean and safe separation. The processor can be fed with panels up to 2 000 mm x 1 400mm and 60 kg.

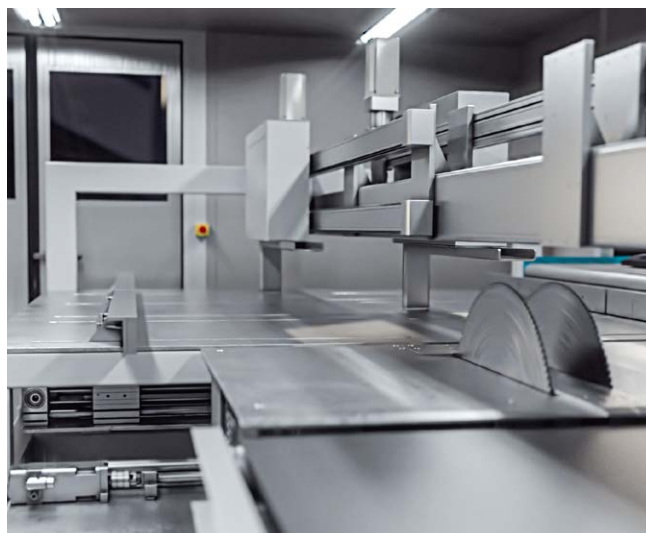

TECHNICAL SPECIFICATIONS FLAT PANEL PROCESSOR (FPP 80/100)

Capacity:

For panels up to 23": up to 80/100 panels/hour
 For panels larger than 23": up to 60/80 panels/hour

Panel stands will have to be removed before processing the panels.
 The machine is enclosed and ventilated.

Media:

Electrical connection:..... 400 V, 50 Hz, max. 32 kW
 Supply pressure: 6 bar

Dimensions: (footprint incl. ventilation station)

Length:..... 9 000 mm
 Width:..... 7 000/10 000 mm
 Height:..... 2 700 mm

Operational temperature range:

..... +3 C° - +35 C°

Outputs:

Flat panels with cut frames allowing for safe and easy removal of CCFLs /mercury backlights.
 PMMA plastics
 Other types of plastic
 Foils

Electronic boards
 Fluorescent lamps
 Metals (aluminium, ferro)

Hg emission to the atmosphere:

Working area: max 0.020 mg/m³
 Exhaust: max 0.020 mg/m³

The Hg concentration is mainly depending on how waste is handled in the room and how maintenance work on the equipment is executed. The machine itself generates only negligible amounts of mercury concentration in the room during operation.

Exhaust:

Exhaust flow: max 1 500 m³/h
 Exhaust duct:..... Ø 160 mm

The process air is discharged through series connected carbon filters.

PURCHASE SPECIFICATIONS AND ADDITIONABLE OPTIONS

The purchase will include the following components:

- 1 pc Flat panel processor including Automatic centring system, Automatic size detection system.
- 1 pc Control system with 13" user friendly touch screen.
- 1 pc Ventilation system including Fan, Dust filter, Carbon filter and Ducts.
- 1 pc Cabin, with following features: Sound proof, Emergency stop push button and Illumination.
- 2 pc Replacement cutting discs
- 1 pc Conveyor with rollers (FPP 100 only)
- 1 pc Conveyor belt
- MRT Premium™ Connect

Options:

- Manual disassembly tables.

EEC Conformity:

- The equipment is manufactured in accordance with:
- EEC Directive on Machinery (2006/42/EG)
- EEC Directive on Low Voltage (2014/35/EG)
- EEC Directive on Electromagnetic Compatibility, EMC (2014/30/EG)

MRT SYSTEM AB

Lumavagen, SE-371 47 Karlskrona, Sweden.
 +46 455 30 28 70 | info@mrtssystem.com
 www.mrtssystem.com

Watch our product videos
 and download our folders
 and product sheets here:

